



## **BUILDING COMMUNITIES**

bridging generations



**BEALS**  
ALLIANCE

75 Iron Point Circle, Suite 175  
Folsom, CA 95630  
t: 916.496.8000 • f: 916.496.8100  
[www.bealsalliance.com](http://www.bealsalliance.com)

---

**F**ounded in 1978, Beals Alliance, Inc., provides landscape architecture services designed to enhance community open-space environments that link individuals with their communities.

**Beals Alliance is dedicated to providing public landscape architecture to benefit the community.**

**We strive to develop an attitude of partnership with our clients, and a collaborative process with the community.**

Beals Alliance provides clients with expertise in designing public outdoor environments, including of parks, waterfronts, public plazas, transportation hubs and stops, streetscapes, bicycle and jogging trails. In addition to our public design expertise, our clients benefit from our long experience in working in the public sector with many different stakeholders. We understand the importance of the public process as well as its challenges and benefits. We've completed over 200 park and public facilities in Northern California—projects which have included community-wide planning workshops, addressing the concerns of special interest groups, park master planning and design, rehabilitation and implementation. Our work encompasses communities of varying sizes and cultures, each one presenting unique challenges and opportunities.

Our projects, delivered for both public and private clientele, include:

- regional, community and neighborhood parks
- municipal facilities, such as airports and civic buildings
- streetscapes and transportation
- sustainability assessments and environmental planning
- educational facilities, such as campus master plans, plazas and quads
- sports parks, skate parks and other active recreation facilities
- trails, shorelines and open spaces



**▶ Klein Park**

Beals Alliance has accomplished projects such as:

- regional, community, and neighborhood parks
- municipal and county facilities, such as civic buildings, airports, museums and historical sites
- streetscapes and transportation projects
- educational facilities, such as campus-wide master plans, plazas and quads
- sports parks, skate parks and other active recreation facilities
- trails, shorelines and open spaces



**Burberry Park ▶**



**At Beals Alliance, we pride ourselves on our vision. While others might visualize “more of the same,” we make an effort to interpret what we’re given and offer alternative choices in order to develop unique solutions.**

### Planning for Success

We feel that it is important that the public agency, user groups, community representatives, and the landscape architect and civil engineer work together to ensure that the design process proceeds toward a unified, relevant and practical design. Beals Alliance will validate the project goals and objectives, define the work product, prepare a timeline and define milestones prior to proceeding with preliminary planning and design.

### Landscape Architectural Design

We provide design and consulting advice to a wide range of clients. Our landscape architecture design portfolio includes work for community groups, recreation departments, school districts, municipal, county and state agencies. Over the years, Beals Alliance has built an extensive portfolio of projects, specializing in beautiful landscapes that are easy to maintain, enhance the community, and provide a sense of place for individuals.

### Leadership

The company was founded by Jay Beals. He continues to be the managing principal and president. Jay has 40 years of experience in the field of landscape architecture with an emphasis in athletic facility planning and design. As a consultant to public agencies, Jay has concentrated his efforts in designing interactive public projects that benefit youth and communities. He has provided successful facilitation, planning, and design of hundreds of public space projects utilizing cooperative community design processes and client partnerships. Jay’s experience in multi-jurisdictional projects provides keen insight and strong leadership for the project team. He was also the founding president of the Northern California Chapter of Sports Turf Managers Association and was instrumental in the Chapter’s widening of memberships from College, University, professional sports members, and K-12 school district members. Jay is involved in various philanthropic activities including services for the development of a memorial to our military and the renovation of Camp Fire Day Camp at Riverbend Park in Sacramento, in which he raised more than \$50,000 through a golf tournament with his Rotary Club.



Centennial Plaza



Three Oaks Park

### A Full Complement of Services

At Beals Alliance, we provide:

- Site Planning
- Site Assessments
- Master Planning
- Usage Audits
- Feasibility Audits
- Sustainability Audits
- Group Process Facilitation
- Standards for Design
- Civil Engineering
- Construction and Maintenance
- Budget Analysis
- Pre and Post-Bond Studies
- Project and Program Management
- Maintenance Analysis
- Design and Engineering
- Production Documentation
- Construction Administration
- Post Construction Review and Analysis
- Graphics

**COMMUNITY & REGIONAL PARKS**

**Burberry Community Park**

Sacramento, CA

Beals Alliance developed a master plan, construction drawings and maintenance standards for this 12 acre park. Meetings were held with

City staff members to gather information and multiple finite plans were developed for the city to review. The park features two soccer fields, a basketball court, a themed play area with a central shade structure, group and individual picnic areas.



Burberry Park ◀

**South Natomas Community Park**

Sacramento, CA

Beals Alliance developed a new Master Plan for the park after conducting meetings with staff and community members, who helped to determine expectations. The Master Plan includes a multi-use sport field with a 75 x 120 yard soccer field, softball field, basketball court and play area. The Plan utilizes an "orchard" theme in keeping with the area's rural roots. The tot lot and play area have a ranch theme conveyed by overhead entrance signage and a large windmill. The landscape is graded with small berms to represent rolling hills.



▶ South Natomas Community Park



San Carlos Beach ◀

**San Carlos Beach**

Monterey, CA

After an extensive public process with a variety of interest groups, Beals Alliance succeeded in developing a master plan to transform a former eye sore at the end of Cannery Row into an accessible beachside park and amphitheater.

**COMMUNITY & REGIONAL PARKS**



**Creekside Park  
Cupertino, CA**

Beals Alliance participated in a six month master planning phase that developed a community and City approved plan. Construction documents included a community building, pedestrian bridge, two large playgrounds, three soccer fields, community building, concessions, restrooms, play areas and half-court basketball. The fields are separated by alleys of trees and auto circulation. This accomplishes a neighborhood feeling even though the park is 13 acres.



▶ Creekside Park Soccer Fields

**Jacob Myers Park Master Plan  
Riverbank, CA**

Jacob Myers Recreation Area occupies 53 acres along the northern banks of the Stanislaus River. Beals Alliance assisted the City of Riverbank and the Friends of Jacob Myers task force with completing a master plan through public process and city council approval. The master plan includes a trail system, parking facilities, amphitheater, lighting, fencing, planting, relocation of the archery range, walk-in camp sites, shade structures, restrooms, and site furnishings. The designs incorporated the program elements, Army Corps of Engineers policies, floodplain restrictions, topography, as well as a heavily used industrial and commuter rail bridge overhead. The plan preserves the existing natural flora, fauna and heritage trees.

**Memorial Park  
San Ramon, CA**

Beals Alliance developed a master plan for turning a tiered parcel into a community park. The project required an abbreviated time frame and extensive public process beginning with establishing a task force, arranging public hearings and making presentations to the Parks and Community Services Commission, City Council and the Parks and Recreation Department. The design program contained a variety of recreational objectives ranging from a sports park to a passive open space preserve. The final master plan utilized the terraced mesa in separate structured play, parking, multi-functional space, open fields, group picnic areas, trails, dog park, and BMX park. The northern promontory features a memorial for the victims of September 11, 2001.

▶ Memorial Park Dedication Area and Ball Field



Memorial Park Play Area ▶



**COMMUNITY & REGIONAL PARKS**



Selma Olinder Park

**Selma Olinder Park**

San Jose, CA

This project focused on the undeveloped fourteen acre parcel within the existing 30 acre park bordering Coyote Creek. The majority of the park was developed away from the creek utilizing a passive and natural setting along its edge. Bike and pedestrian trails meander along the creek and native grass field. A large open turf area was installed for mixed use and softball. The remainder of the developed portion includes a picnic

shelter, tennis courts, restrooms, storage facility, parking lot and an outdoor classroom for the children at Olinder Elementary School.

**Gibbons Park Sustainability Plan**

Carmichael, CA

Beals Alliance created a sustainability assessment of the 17.5 acre Gibbons Park for the Mission Oaks Recreation and Park District, which identifies the highest and best use of the landscape that respects the environmental, economical, and social factors of the site. The study addresses a variety of sustainable design topics, including topography, soils, water, vegetation, and energy.



Gibbons Park Sustainability Plan

**Tijuana River Valley Regional Park**

San Diego County, CA

In the heart of the Tijuana River Valley Regional Park flood plain, Beals Alliance developed an environmentally responsive master plan encompassing the beauty of the surrounding park land with the programmatic desires of the surrounding community and flood lands. Elements that are included within this regional facility are 10 soccer fields with 2 championship fields, 2 multi-use soccer/softball fields, 4

multi-use synthetic softball fields, community play areas, 3 basketball courts, 3 tennis courts, bmx/skate park, 2 bocce ball courts, restroom, concession stands, photovoltaic power sources, and a water detention basin.

Tijuana River Valley Regional Park



**COMMUNITY & REGIONAL PARKS**



**Central Park Play Area Renovation**

Santa Clara, CA

**Delaveaga Regional Park**

Santa Cruz, CA

City of Santa Cruz, Park & Recreation Department

**Finley Park**

Santa Rosa, CA

**Fresno Regional Park**

Fresno, CA

Boyle Engineering

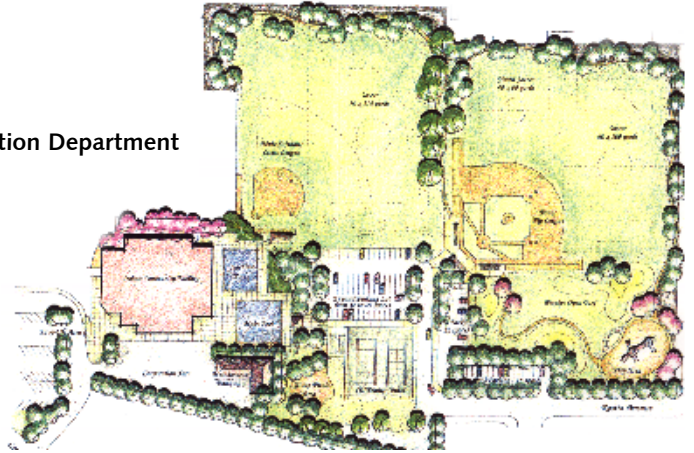

**Gilroy Ranch Regional Park**

Gilroy, CA



Rosita Avenue Park  
Master Plan

**River Bluff Regional Park**

Ceres, CA

**Rosita Avenue Park**

Los Altos, CA

**Uvas Creek Park Preserve**

Gilroy, CA



Lovers Point Park



**Guadalupe River Park**

Downtown San Jose, CA

San Jose Redevelopment Agency

**Lover's Point Park**

Pacific Grove, CA

**Redding Plunge Swimming Pool  
Complex Renovation**

Redding, CA



Uvas Creek Park Preserve

Vasona Play Area

**Shannon Park**

Dublin, CA

**Three Oaks Park**

Cupertino, CA

**Vasona County Park Play Area**

Los Gatos, CA

County of Santa Clara Parks and Recreation Department

## NEIGHBORHOOD PARKS

### Houge Park

San Jose, CA

Beals Alliance developed designs and plans for the renovation of the play areas and restrooms, creating a thematic play experience for the neighborhood children. The community selected a transportation theme for the younger children, and a large scale play experience for the older children. Additional funding allowed the renovation project to extend to the adjacent picnic and plaza areas and new lighting for the park.



Houge Park's  
Themed Tot-lot

### Nordstrom Park\*

Morgan Hill, CA

Adjacent to a busy avenue and elementary school, Nordstrom Park presented a variety of challenges, including a storm water detention basin. Beals Alliance developed the park's master plan, facilitated the public process and provided design development and construction documentation. Park elements were designed around the perimeter of the 2 acre basin. The park features two age-appropriate play areas, half court basketball, picnic areas, pathways and a small parking lot.



Nordstrom Park

\* NCTLC 2nd Place: Design New Commercial Landscape, 2002

\* NCTLC 3rd Place: Commercial New Construction, 2002

### Calaveras Neighborhood Park\*

Hollister, CA

This park design recognizes two user groups, neighborhood residents and students from the adjacent Calaveras School. Beals Alliance developed a master plan featuring a playground, picnic pavilion, amphitheater, restrooms and ball fields. The amphitheater provides a space for outdoor learning for the school children and "Sundays in the Park" music program on weekends. The ball fields are suitable for league play and student recreation.

\* ARCO Facilities Planning Award, CPRS, 1991

### Marsalli Park\*

Santa Clara, CA

Beals Alliance designed a "take me out to the ball game" themed play area to tie in with the existing park. It features rubberized and accessible surfaces to represent the "pitching mound" and "infield." Play structures are located in the "outfield." Entrance-way flags, game play panels and score boards complete the theme. Beals Alliance also designed a larger play structure and open play areas for older children.

\*NCTLC 1st Place: New Project Commercial Design, 2002



Calaveras Neighborhood  
Park

**NEIGHBORHOOD PARKS**



Patriots Park ◀

**Patriots Park\***

**Carmichael, CA**

Carmichael Recreation and Park District selected Beals Alliance to develop specific site master plan which was completed and approved in 2007. The 3.8 acre park includes play area, pathway, street improvements and was opened in 2008.

\*CPRS Facility Design & Park Planning Award Winner

**Renz Neighborhood Park\***

**Gilroy, CA**

The drought between 1981 and 1992 prompted the City of Gilroy to commission a water-efficient demonstration garden to replace a turf-intensive, high water consumption, neighborhood park. Beals Alliance met with residents and Parks department staff to develop a long term master plan and construction documents. After small neighborhood workshops, a master plan was drafted and implemented.

\*Demonstration Garden Award, Water Efficient Landscape Conference, SCVWD, 1993



**Jan Drive Park**

**Carmichael, CA**

Beals Alliance developed a Master Plan of 13.6 acre Jan Drive Park for the Carmichael Recreation & Park District. Jan Drive Park site is an underdeveloped neighborhood park which includes a riparian area with seasonal water. The Master Site Plan includes connectivity to the surroundings, development of the trail system, group and individual picnic areas, and other passive recreational opportunities.



Renz Park Demonstration Gardens ◀

**Northwoods Park**

**Citrus Heights, CA**

Developing the connectivity of existing residential parks, Beals Alliance developed a two phase master plan of a recreational trail system expansion from existing Northwoods park for Sunrise Recreation & Park District. A two part master plan was develop based upon community members responses that maintained an the overall passive, natural and open feel of the existing Northwoods park site, while also providing focused areas of development to enhance new user group experiences.

▶ Northwoods Park



**NEIGHBORHOOD PARKS**

**Calle Del Rey**

Gilroy, CA

**Concar Park**

San Mateo, CA

**Country Club School Park**

San Ramon, CA

**Creekbridge Park**

Salinas, CA

**Dana Park**

Mountain View, CA

**Fuller Street Park**

Santa Clara, CA

**Gardener Bierbach Park**

San Jose, CA

**Holly Creek Park**

Oakley, CA

**Jackson Park**

Mountain View, CA

**Larkin Neighborhood Park**

Monterey, CA



▶ Concar Park Play Area



Country Club School Park ◀



▶ Dana Park



▶ Holly Creek Park includes a soccer field and water feature

NEIGHBORHOOD PARKS

**Doerr Park**

San Jose, CA

**Indian Springs Park**

San Mateo, CA

**LoBue Park**

San Jose

**Mantelli Neighborhood Park**

Gilroy, CA

**Mariner's Island Park**

San Mateo, CA



▶ Lo Bue Park

**Max Baer Park**

Sacramento, CA

**Paul Moore Park**

San Jose, CA

**Morgan Hill Parks,  
ADA Renovations**

Morgan Hill, CA

**Noble Park**

San Jose, CA



Doerr Park Play Area ◀

**Oak Newton Park**

Monterey, CA

**Rudgear Park**

Walnut Creek, CA

**San Ysidro Park**

Gilroy, CA

**Silva Park**

Riverbank, CA

**Verano Creek Park**

Sacramento, CA

**Walt Disney Neighborhood Mini-Park**

San Ramon, CA

**Wool Creek Park**

San Jose, CA



▶ Max Baer Park,  
Sacramento



▶ **Beals Alliance** partners with communities to design parks that bring neighbors together, offer a sense of belonging and provide children with safe and imaginative play experiences.

**SPORTS PARKS**

**Mather Sport Center**

Rancho Cordova, CA

A 30-acre facility with a total project budget of over \$13 million. This is a master plan project that has been through the public process, design process, and will follow with implementation over a couple years. Project elements include ADA compliant restrooms, skate/BMX park, in-line hockey arena and basketball courts, lighting and parking, full service group picnic with shade trees, tot lot, lighting for ball field #1 and backstops and fencing at ball fields #1, #2 and #3.

- \*ASBA Multi-Purpose Turf Facility of the Year Award Winner
- \*CPRS Facility Design: Sports Field/Complexes Award Winner



▶ Mather Sports Center Conceptual Design developed using our own computer-based Interactive Workshop Environment (IWE)

**Fresno Regional Park**

Fresno, CA

Using a shoreline landfill, the City of Fresno and Beals Alliance transformed a former city dump to a state-of-the-art sports park. The park includes six adult league softball fields featuring centralized concessions and restrooms. Fifteen soccer fields support play for under-8 divisions to regulation tournaments.



Fresno Regional Park ◀

**Santa Clara Youth Soccer Park**

Friends of Santa Clara Soccer Park

Beals Alliance worked with this non-profit coalition to develop a three phase comprehensive soccer complex. The \$4.5 million, 11.1 acre complex contains three premier lighted soccer fields, two of which are sand-based and one is new generation synthetic turf. Stadium seating was provided, as well as on-site parking, major infrastructure improvements, and perimeter beautification improvements.



▶ Santa Clara Youth Soccer Park



**SPORTS PARKS**

**Dan Foley Park\***

Vallejo, CA

Four acre synthetic turf park for soccer & little league synthetic turf fields, restroom, concession, storage, ADA access improvements, dugouts and spectator viewing areas.

\*CARPD Best Renovated Facility Award Winner



▶ Dan Foley Park

**Shoreline Athletic Complex**

Mountain View, CA

The complex consists of one large multi-use synthetic turf field which is located atop the region's old closed shoreline landfill site. The multi-use facility can be programmed for a multitude of community uses including 2 adult or little league baseball fields/slow or fast pitch softball fields and can also be striped to hold 2 adult soccer fields or multiple u8/u10 kids soccer fields. The facility will also have a restroom/concession building, sports field lighting, play areas and new landscaping.



◀ Shoreline Athletic Complex

**Grape Bowl**

Lodi, CA

Replacement of existing field with a new synthetic football and soccer field for use by the local high schools and for the public. Improvements include upgrades to the irrigation system, storm water collection and detention system and ADA upgrades.

**Horse Creek Soccer Complex at Centennial Park**

Vacaville, CA

This 40 acre park currently has 1 Pony League/ Babe Ruth field, 3 Little League fields, 4 VYSL soccer fields, outdoor roller hockey court, 4 tennis courts, a hiking trail, on-site parking for approximately 300 cars, restroom and concession complex. We have master planned for soccer fields and updating of ADA.



▶ Horse Creek Soccer Complex at Centennial Park

**SPORTS PARKS**



**Gilroy Sports Park**

**Gilroy, CA**

The design for this multi-use sports complex maximizes the use of a 1% flood plane area. A 2-in-1 design places soccer fields between baseball/softball fields. Two of these configurations are located side by side split by a walkway which links all facilities to the central driveway and parking spine. Programmatic and fiscal participation from the Little League and soccer leagues have resulted in plans for a premier facility in the southeast corner of the site.



▶ Gilroy Sports Park

**River Bluff Regional Park**

**Ceres, CA**

The program for this sports park was to reduce the overcrowding occurring at existing sports facilities in the City of Ceres. The upper terrace incorporates sports programs, while the lower terrace focuses on the native restoration of a floodway. After input from a community task force, presentations and interactive computer workshops, user groups refined the final programming needs for the 8 sports fields. The design integrates soccer and softball fields, basketball and volleyball courts, picnic areas, concession/restroom building, trails and non-motorized boating.



**South San Jose Soccer Complex**

**City of San Jose, Morgan Hill, Morgan Hill Unified School District**

Working with soccer representatives, City of San Jose, City of Morgan Hill and Morgan Hill Unified School District, Beals Alliance developed several iterations of the design to meet the needs of each interest group. Twenty full size soccer fields were included along with parking, corporation yard, entry ticketing area, and a central tournament area.



▶ Tracy Youth Sports Facility

**Tracy Youth Sports Facility**

**Tracy, CA**

The City of Tracy commissioned Beals Alliance to develop a Master Plan for a 198 acre site. Using interactive computer workshops to integrate the needs of sport user groups and the community with those of the City, Beals Alliance created a program that included baseball, softball, football and soccer facilities.

**Caglia Fields, San Jose**

**Almaden Youth Association**

Beals Alliance developed a Master plan for a 79 acre sports park located in the southeast quadrant of San Jose. The athletic facilities in the complex include six regulation 75x115 yard soccer fields, a football field, two girls fast pitch diamonds, and one four-plex for Little League.

**SPORTS PARKS**

**Cordelia Tri-Valley Little League**

Cordelia Tri-Valley Little League

Beals Alliance developed a preliminary plan for this Little League complex. The plan included two Little League baseball fields with a support building located between the two backstops. The Cordelia Tri-Valley Little League fields were completed as part of Beals Alliance's Youth Benefactor Program.



Cordelia Tri-Valley Little League ▶

**Chrisman Sports Park**

Tracy, CA

Beals Alliance developed a plan for the 110 acre site in conjunction with the City of Tracy and the Youth Sports Alliance of Tracy. The plan created over twenty baseball fields, sixteen soccer fields, four softball fields and three football fields for use by the youth leagues.

**Country Club School Park**

San Ramon Valley Unified School District

Beals Alliance provided a master plan, final design and construction documents for three softball fields, two soccer fields, play structures for 3 levels of play, two sand volleyball courts, an exercise station and neighborhood mini-park in the north corner.

**Morgan Hill Sports and Aquatics Complex**

Morgan Hill, CA

The City of Morgan Hill asked Beals Alliance to develop a Conceptual Master Plan for the proposed sports and aquatics complex. We met with representatives from Morgan Hill, user and community groups to develop and refine the conceptual designs. Elements include 6 soccer, 4 softball and 4 baseball fields as well as a competitive and recreational aquatic complex located on about 41 total acres.

**Riverbank Sports Complex**

Riverbank, CA

Understanding the City's goals for future expansion, Beals Alliance developed a two phase Master Plan for a sports complex. Phase I elements include soccer fields, concessions/restroom/storage building and parking, as well as a picnic/barbecue area and perimeter walking path. The second phase features more soccer fields with spectator seating, adult softball field, little league/youth fields, bicycle stunt course, play areas with shade structure, picnic areas and additional parking.



▶ Our Youth Benefactor Program helps leagues provide safe and enjoyable competitive sports experiences

▶ Morgan Hill Sports Complex



**SPORTS PARKS**

**Stockton Sports Park**

Stockton, CA

Beals Alliance developed a master plan for this softball complex to be built over an existing landfill site shared with a commercial area. A central corridor was established to cut through the commercial site and lead to the main entrance of the sport complex. The complex features 14 synthetic turf fields for girls fastpitch softball, a concession building, restaurant, pro shop, arcade room, restrooms



**Chicago Cubs Training Facility/ Legacy Sports Park**

Mesa, AZ

The Legacy Sports Park of Mesa, LLC consulted with Beals Alliance to create a Master Plan for the construction of the new spring training facility being designed exclusively for the Chicago Cubs. They will be a cornerstone partner with a state-of-the-art \$225 million dollar, 300-acre, year-round property that is a destination for sports fans.



▶ Chicago Cubs Training Facility/ Legacy Sports Park

**Napa Memorial Stadium**

Napa, CA

Memorial Stadium ranked as the #4 High School Football stadium nationally in 2008 and home to both Napa and Vintage High Schools. Beals Alliance with the guidance of the Napa community members and Quattrocchi Kwok

Architects, took on the challenge of modernizing the stadium to provide the necessary modern amenities and to bring the highly regarded stadium into the 21st century. The new stadium scheduled to open in fall of 2010 will encompass renovated parking, ticket entries, concessions, restrooms, press boxes, elevators, handicap accessible bleachers, team rooms, entry plaza, scoreboard, rain water harvesting, and a state of the art synthetic field.



▶ Napa Memorial Stadium



**SPORTS PARKS**



**Granite Park 24/7 Soccer Field**  
Sacramento, CA

**Ortega/Stockelmeier Athletic Fields**  
Sunnyvale, CA

**Pleasanton Sports Park**  
Pleasanton, CA

**Plata Arroya Skatepark**  
San Jose, CA



▶ Plata Arroya Skatepark



Granite Regional Park ▶

**Albany-Berkeley Youth Sports Complex**  
Albany, CA

**San Jose Regional Skate Park**  
San Jose, CA

**Sunnyvale Skatepark**  
Sunnyvale, CA

**Stanislaus County Regional Sports Facility Study**  
Modesto, CA

**Washington Sports Park**  
Sunnyvale, CA

**Watson Skatepark**  
San Jose, CA



▶ Washington Sports Park

**CITY PLAZAS & PUBLIC BUILDING LANDSCAPES**

**Monterey County Government Center  
Salinas, CA**

The County of Monterey remodeled their Government Center and add a State Courthouse. The landscaping of this new building needed to be low maintenance and very water efficient, but it also had to reflect the important function of the courthouse. Pine trees were placed near the three story glass entry way. A “mall” of lush, flowering trees were planted to add a monumental feel reminiscent of the cherry trees in the Capitol Mall in Washington, D.C. With the development of the other buildings in the government center, landscape details were judiciously introduced in appropriate areas to appear as if they had been there for the past 50 years. Old fountains were renovated so the calming sound of water could again be heard along the mall. Special care was taken with the lighting elements to provide security, yet not overpower the area. Along with pedestrian level bollards, gently-scaled light standards and up-lighting were used for dramatic impact.



▶ Monterey County Government Center Entry Way



▶ Monterey County Government Center

**Centennial Plaza\*  
Mountain View, CA**

\*APWA Honor Award, 2003

**Mission San Jose Bicentennial Plaza  
Fremont, CA**

City of Fremont Development & Environmental Services Department



▶ Centennial Plaza\*  
\*APWA Honor Award

**Parque De Los Pobladores Urban Plaza\*  
San Jose, CA**

San Jose, CA  
Redevelopment Agency of San Jose

\*CLCA Achievement Award; Northern California Chapter ASLA Honor Award; ASLA National Honor Award, 1988

▶ Children's Discovery Museum

**Children's Discovery Museum  
San Jose, CA**

Redevelopment Agency of San Jose



**CITY PLAZAS & PUBLIC BUILDING LANDSCAPES**

**Guadalupe River Urban Plaza**

Downtown San Jose, CA  
San Jose Redevelopment Agency

**Los Altos Civic Center**

Los Altos, CA

**Monterey Bay Aquarium**

Monterey, CA

**Morro Bay City Center**

Morro Bay, CA



▶ Monterey Bay Aquarium

**Murphy Square**

Sunnyvale, CA

**Pellier Historic Estate**

San Jose, CA  
San Jose Beautiful,  
Redevelopment Agency of  
San Jose, and the San Jose  
Departments of Public Works,  
Traffic, Planning, Parks and  
Recreation



Murphy Square ◀

**Palo Alto Senior Center**

Palo Alto, CA  
City of Palo Alto

**San Jose Children's Shelter**

San Jose, CA

**San Jose International Airport**

San Jose, CA



▶ San Jose Children's Shelter



Shoreline Amphitheater ◀

**Shoreline Amphitheater & Mountain View Coastal Access**

Mountain View, CA

**STREETSCAPES & TRANSPORTATION PROJECTS**



Saratoga Avenue ◀

**Saratoga Avenue Medians**

Santa Clara CA

The mile-long stretch of busy thoroughfare had been planted over 30 years earlier. The medians featured mature trees, majestic Canary Island Pines, Ginko and others, but the shrub planting and entry elements had shown the effects of time. **Beals Alliance** developed a master plan for the City of Santa Clara that included focal points, special plant paletts signage and special night lighting.

**Butterfield Boulevard Bicycle Trail**

Morgan Hill, CA

**Downtown San Jose Streetscapes**

San Jose, CA

San Jose Redevelopment Agency

**East Campbell Avenue Streetscape**

Campbell, CA

**Edenvale Redevelopment Project**

San Jose, CA

**Redwood Shores Median**

Redwood City, CA

**Adobe Creek Restoration and Flood Control Improvements**

Palo Alto & Los Altos, CA

**Matadero Creek Landscape Mitigation**

Palo Alto, CA

Santa Clara Valley Water District

**Mather Field Roadway Improvements,**

Sacramento, CA

County of Sacramento, Department of Public Works, Transportation Division

**VTA Lightrail, 10 North Line Platforms**

San Jose, CA

Valley Transportation Authority

**North 85/101 Highway Interchange**

Mountain View, CA



▶ North 85/101 Highway Interchange



Santa Clara Street ◀



▶ VTA Light Rail Platform

---

a w a r d s

---

**CARPD Best Renovated Facility Award**

Dan Foley Park, Vallejo, CA, 2011



**ASBA Distinguished Dual Field Award**

UNLV Rebel Practice Facility, Las Vegas, NV, 2010

**ASBA Distinguished Single Field Award**

California State University Sacramento, Sacramento, CA 2010

**ASBA Outdoor Track of the Year Award**

Ponderosa High School, Placerville, CA, 2010

**ASBA Distinguished Outdoor Track Award**

Center High School, Antelope, CA, 2010

Sheldon High School, Elk Grove, CA, 2010

**CPRS Facility Design: Sports Field/Complexes Award**

Mather Sports Center, Rancho Cordova, CA, 2009

**ASBA Multi-Purpose Turf Facility of the Year Award**

Mather Sports Center, Rancho Cordova, CA, 2009

**ASBA Distinguished Multi-Purpose Turf Facility Award**

Livermore Community Park, Livermore, CA, 2009

**ASBA Distinguished Outdoor Track Award**

Natomas & Inderkum High School Track & Field, Sacramento, CA, 2009

Running Track Facility at San Joaquin Delta College, Stockton, CA, 2009

**ASBA Distinguished Sports Field Award**

Sports Fields at San Joaquin Delta College, Stockton, CA, 2009

**CPRS District II Facility Design & Park Planning**

Patriots Park, Carmichael, CA, 2009

**ASBA Outstanding Track Complex**

Armijo High School, Fairfield, CA, 2006

**ASBA Outstanding Track Complex**

Sacred Heart Schools, Atherton, CA, 2005

Andrew Hill High School, San Jose, CA, 2005

Piedmont Hills High School, San Jose, CA, 2005

**ASBA Outstanding Tennis Complex**

Sacred Heart Schools, Atherton, CA, 2005

---



Ribbon cutting on grand opening day at Patriots Park



San Jose Children's Shelter



**Synthetic Turf and All-Weather Track 101 & Management of Synthetic Turf & All-Weather Track**

Paramount Unified School District Workshop 2011  
Paramount, CA

**Meet Management: A General Overview of How a High School Track & Meet Operate**

ASBA Conference 2010  
Ponte Vedra Beach, FL

**Opportunities For Success With Living Turf Management in Parks**

CPRS Conference 2009  
Santa Clara, CA

**Community Sports Complex: From Concept to Bid**

STMA Conference 2009  
San Jose, CA

**Synthetic Turf Managers Presentation and Q&A (Panel)**

STMA Conference 2009  
San Jose, CA

**Baseball 101**

ASBA Conference 2008  
New Orleans, LA

**Designing for Revenue & Sustainable Operations**

NRPA Reitz Marketing & Revenue Sources Management School  
2008  
San Diego, CA

**Synthetic Turf 101: Use & Application**

CCSTC 2008  
Fresno, CA

**Design with the End in Mind**

CPRS Park Management & Development Institute 2008  
Woodland, CA

**Use of Synthetic Turf In Public Spaces**

NRPA Conference 2007  
Indianapolis, IN

**Design Your Park Three Dimensionally**

CARPD Conference 2007  
Lake Tahoe, CA

**Introduction to Use of Synthetic Turf In Public Spaces**

CPRS, District I, 2007  
Marin, CA

**Life Cycle and Cost of Synthetic vs "Natural" Turf**

CPRS District I, 2007  
Marin, CA

---



**Jay Beals**  
Managing Principal



▶ Monterey County  
Government Center

▶ **"It's so important to form quality relationships with our clients. It fosters the kind of open communication that makes a big difference to the success of the project"**  
~ Jay Beals

